



www.phd-mfg.com

THREADED ACCESSORIES

FIG. 15 & 15L

MACHINE THREAD HANGER ROD

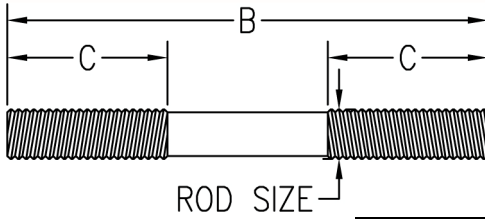

Function: Designed for use in pipe hanger assemblies.
 Right-Hand Threads (**Fig. 15**) or Right and Left-Hand Threads (**Fig. 15L**).
Material: Carbon steel (Type 304 or 316 Stainless Steel upon request)
Finish: Plain or electro-galvanized (Hot dipped galvanized upon request)
Ordering: Specify figure number, rod size, length (B), material, and finish.

| Rod Size | Thread Length C | | Max. Rec. Load | | | | Wt. Per Inch | |
|----------|-----------------|---------|----------------|---------|---------------|---------|--------------|-------|
| | | | 650°F (343°C) | | 750°F (399°C) | | lbs. | kg |
| | | | lbs. | kN | lbs. | kN | | |
| 3/8 x B | 2 1/2 | (63.5) | 730 | (3.25) | 572 | (2.54) | .03 | (.01) |
| 1/2 x B | 2 1/2 | (63.5) | 1350 | (6.01) | 1057 | (4.70) | .06 | (.03) |
| 5/8 x B | 2 1/2 | (63.5) | 2160 | (9.61) | 1692 | (7.52) | .09 | (.04) |
| 3/4 x B | 3 | (76.2) | 3230 | (14.37) | 2530 | (11.25) | .13 | (.06) |
| 7/8 x B | 3 1/2 | (88.9) | 4480 | (19.93) | 3508 | (15.61) | .17 | (.08) |
| 1 x B | 4 | (101.6) | 5900 | (26.24) | 4620 | (20.55) | .22 | (.10) |

Unless otherwise specified, all dimensions on drawings and in charts are in inches and dimensions shown in parentheses are in millimeters.

THREADED ACCESSORIES
 CPVC STRAPS
 BAND HANGERS
 BEAM CLAMPS
 CLEVIS HANGERS
 PIPE ROLLER SUPPORTS
 PIPE RING HANGERS
 SPLIT RING HANGERS
 PIPE CLAMPS
 CENTER LOAD BEAM CLAMPS
 PIPE SHIELDS, INSULATION, & SADDLES
 PIPE GUIDES & SLIDES
 WALL BRACKETS
 PIPE SUPPORTS
 STRUCTURAL ATTACHMENTS
 SEISMIC BRACING