

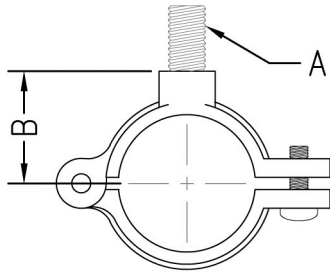

www.phd-mfg.com

SPLIT RING HANGERS

FIG. 512H HINGED COPPER TUBING EXTENSION SPLIT CLAMP



Function: Designed for non-insulated stationary tubing lines in either a horizontal or vertical position. The hinged design of Fig. 512H allows for a quicker installation.

Material: Malleable iron

Finish: Copper color epoxy finish

Approvals: Complies with Federal Specification A-A-1192A (Type 12) and Manufacturers' Standardization Society ANSI/MSS SP-58 (Type 12) which supersedes ANSI/MSS SP-69.

Ordering: Specify figure number and pipe size.

Tube Size	Bolt Thread A	B		Max. Rec. Load		Wt. Each		
				lbs.	kN	lbs.	kg	
3/8	(10)	3/8	9/16	(14.29)	180	(0.80)	.08	(.04)
1/2	(15)	3/8	11/16	(17.46)	180	(0.80)	.09	(.04)
3/4	(20)	3/8	7/8	(22.23)	180	(0.80)	.12	(.05)
1	(25)	3/8	1	(25.40)	180	(0.80)	.11	(.05)
1 1/4	(32)	3/8	1 1/8	(28.58)	180	(0.80)	.15	(.07)
1 1/2	(40)	3/8	1 5/16	(33.34)	180	(0.80)	.20	(.09)
2	(50)	3/8	1 1/2	(38.10)	180	(0.80)	.25	(.11)
2 1/2	(65)	1/2	1 7/8	(47.63)	300	(1.33)	.45	(.20)
3	(80)	1/2	2 1/8	(53.98)	300	(1.33)	.55	(.25)
4	(100)	1/2	2 3/4	(69.85)	300	(1.33)	.90	(.41)

THREADED ACCESSORIES
CPVC STRAPS
BAND HANGERS
BEAM CLAMPS
CLEVIS HANGERS
PIPE ROLLER SUPPORTS
SPLIT RING HANGERS
PIPE CLAMPS
PIPE LOAD BEAM CLAMPS
PIPE SHIELDS, INSULATION, & SADDLES
PIPE GUIDES & SLIDES
WALL BRACKETS
PIPE SUPPORTS
STRUCTURAL ATTACHMENTS
SEISMIC BRACING