

THREADED ACCESSORIES



FIG. 25

EXTENSION PIECE

Function: Designed for attaching hanger rod to various types of attachments. Allows for vertical adjustment of the rod. Frequently used in conjunction with Fig. 630 malleable iron beam clamp.

Material: Malleable iron

Finish: Plain or electro-galvanized

Ordering: Specify figure number, rod size, and finish.

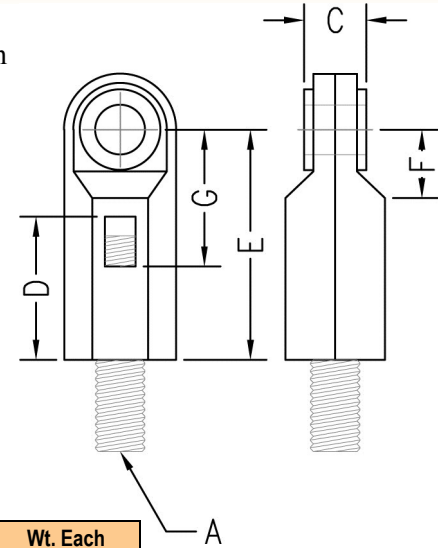

Rod Size A	For Pipe Sizes		B		C		D	
3/8	1/2 to 2	(15 to 50)	1/2	(12.7)	1/2	(12.7)	1 1/4	(31.75)
1/2	2 1/2 to 3 1/2	(65 to 90)	1/2	(12.7)	5/8	(15.88)	1 3/8	(34.93)
5/8	4 & 5	(100 & 125)	1/2	(12.7)	5/8	(15.88)	1 1/2	(38.1)
3/4	6 & 8	(150 & 200)	1/2	(12.7)	5/8	(15.88)	1 3/4	(44.45)
7/8	10 & 12	(250 & 300)	9/16	(14.29)	3/4	(19.05)	1 7/8	(47.63)

Rod Size A	E		F		G		Max. Rec. Load		Wt. Each	
							lbs.	kN	lbs.	kg
3/8	2 1/16	(52.39)	9/16	(14.29)	1 1/4	(31.75)	730	(3.25)	.20	(.09)
1/2	2 5/16	(58.74)	1 1/16	(17.46)	1 3/8	(34.93)	1350	(6.01)	.43	(.20)
5/8	2 7/16	(61.91)	3/4	(19.05)	1 7/16	(36.51)	1550	(6.89)	.46	(.21)
3/4	2 7/8	(73.03)	7/8	(22.23)	1 1 1/16	(42.86)	2100	(9.34)	.63	(.29)
7/8	3	(76.2)	7/8	(22.23)	1 3/4	(44.45)	2350	(10.45)	.67	(.30)