

INSULATION SHIELDS

FIG. 160

SELF CENTERING INSULATION SHIELD

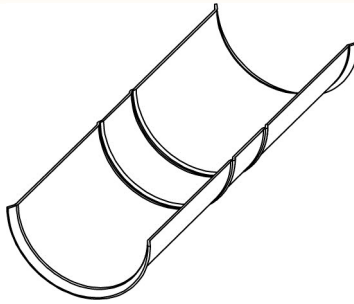

Function: Designed to provide maximum protection to the insulation. The centering ribs are spaced to center the hanger on the shield, providing equal load distribution. The shield is furnished with flared ends to prevent it from cutting into the insulation.

Material: Carbon steel (Type 304 or 316 Stainless Steel upon request)

Finish: Pre-galvanized

Ordering: Specify figure number, shield number, and material.

NOTE: To determine proper size consult shield selection guide.

Size No.	Shield I.D.		Shield Length		Shield Gauge	Hanger Size		Rib Spacing		Wt. Each	
		(mm)		(mm)			(mm)		(mm)	lbs.	kg
1	2 ³ / ₈	(60.33)	8	(203.20)	18	2	(50)	1 ¹ / ₄	(31.75)	.35	(.16)
2	2 ⁵ / ₈	(66.68)	8	(203.20)	18	2 ¹ / ₂	(65)	1 ¹ / ₄	(31.75)	.37	(.17)
3	2 ⁷ / ₈	(73.03)	8	(203.20)	18	2 ¹ / ₂	(65)	1 ¹ / ₄	(31.75)	.42	(.19)
4	3 ¹ / ₂	(88.90)	8	(203.20)	18	3	(80)	1 ¹ / ₄	(31.75)	.56	(.25)
5	4	(101.60)	8	(203.20)	18	3 ¹ / ₂	(90)	1 ¹ / ₄	(31.75)	.63	(.29)
6	4 ¹ / ₂	(114.30)	8	(203.20)	18	4	(100)	1 ¹ / ₄	(31.75)	.72	(.33)
7	5	(127.00)	8	(203.20)	18	5	(125)	1 ¹ / ₄	(31.75)	.82	(.37)
8	5 ⁵ / ₈	(142.88)	8	(203.20)	18	5	(125)	1 ¹ / ₄	(31.75)	.92	(.42)
9	6	(152.40)	8	(203.20)	18	6	(150)	2	(50.80)	.98	(.44)
10	6 ⁵ / ₈	(168.28)	8	(203.20)	18	6	(150)	2	(50.80)	1.08	(.49)
11	7 ⁵ / ₈	(193.68)	12	(304.80)	18	8	(200)	2	(50.80)	2.16	(.98)
12	8 ⁵ / ₈	(219.08)	12	(304.80)	18	8	(200)	2	(50.80)	2.43	(1.10)
13	9 ⁵ / ₈	(244.48)	12	(304.80)	18	10	(250)	2	(50.80)	2.73	(1.24)
14	10 ³ / ₄	(273.05)	12	(304.80)	18	10	(250)	2	(50.80)	3.06	(1.39)
15	11 ³ / ₄	(298.45)	12	(304.80)	18	12	(300)	2 ¹ / ₄	(57.15)	3.34	(1.51)
16	12 ³ / ₄	(323.85)	12	(304.80)	18	12	(300)	2 ¹ / ₄	(57.15)	3.60	(1.63)
17	14	(355.60)	12	(304.80)	18	14	(350)	2 ¹ / ₄	(57.15)	3.96	(1.80)
18	15	(381.00)	12	(304.80)	18	16	(400)	2 ³ / ₄	(69.85)	4.23	(1.92)
19	16	(406.40)	12	(304.80)	18	16	(400)	2 ³ / ₄	(69.85)	2.35	(1.07)
20	17	(431.80)	12	(304.80)	18	18	(450)	2 ³ / ₄	(69.85)	2.80	(1.27)
21	18	(457.20)	12	(304.80)	18	18	(450)	2 ³ / ₄	(69.85)	5.08	(2.30)
22	19	(482.60)	12	(304.80)	18	20	(500)	3 ¹ / ₄	(82.55)	5.36	(2.43)
23	20	(508.00)	12	(304.80)	18	20	(500)	3 ¹ / ₄	(82.55)	5.56	(2.52)
24	21	(533.40)	12	(304.80)	18	24	(600)	3 ¹ / ₄	(82.55)	5.90	(2.68)