



www.phd-mfg.com

CPVC STRAPS

FIG. 070

CPVC TWO-HOLE PIPE STRAP

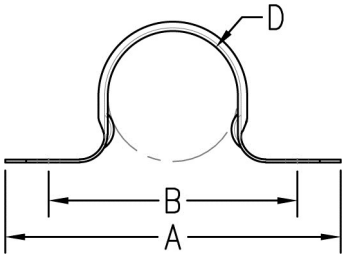

Function: Designed to support CPVC pipe horizontally from the side or bottom of beam. Fig. 070 can only be used as a guide on top of beam or on vertical piping. Fig. 070 also acts as a restrainer to prevent the thrust of a sprinkler head during activation when mounted on top of structure. Fig. 070 may be installed onto wood using supplied fasteners or into, minimum 20 gauge, steel using two 1/4" X 1" tek type screws (not included). Features flared edges to protect piping as it slides through the installed fitting and retaining dimples to allow for easy installation onto pipe.

Size: 3/4" (20) through 2" (50) CPVC pipe.

Material: Carbon Steel

Finish: Pre-galvanized

Approvals: Underwriters Laboratories listed for US and Canada.

Ordering: Specify figure number and pipe size.

Pipe Size		A		B		D Nominal		Box Qty.	Max. Spacing		Appx. Wt. Per 100	
									ft.	m	lbs.	kg
3/4	(20)	3 1/16	(77.79)	2 3/16	(55.56)	1.050	(26.67)	100	5.5	(1.68)	7.50	(3.40)
1	(25)	3 3/8	(85.73)	2 1/2	(63.50)	1.315	(33.40)	100	6	(1.83)	8.20	(3.72)
1 1/4	(32)	3 3/4	(95.25)	2 7/8	(73.03)	1.660	(42.16)	100	6.5	(1.98)	9.40	(4.26)
1 1/2	(40)	4 1/8	(104.78)	3 1/4	(82.55)	1.900	(48.26)	100	7	(2.13)	10.40	(4.72)
2	(50)	4 3/8	(111.13)	3 1/2	(88.90)	2.375	(60.33)	100	8	(2.44)	11.90	(5.40)

THREADED ACCESSORIES
CPVC STRAPS
BAND HANGERS
BEAM CLAMPS
CLEVIS HANGERS
PIPE ROLLER SUPPORTS
SPLIT RING HANGERS
PIPE CLAMPS
CENTER LOAD BEAM CLAMPS
PIPE SHIELDS, INSULATION, & SADDLES
PIPE GUIDES & SLIDES
WALL BRACKETS
PIPE SUPPORTS
STRUCTURAL ATTACHMENTS
SEISMIC BRACING



PHD Manufacturing, Inc.

44018 Columbiana-Waterford Road
 Columbiana, Ohio 44408-9481
 Phone: 800-321-2736 • 330-482-9256
 Fax: 330-482-2763
 Web: www.phd-mfg.com

FIGURE 070 INSTALLATION INSTRUCTIONS

FUNCTION: Designed to support CPVC pipe horizontally from the side or bottom of beam. **Fig. 070 can only be used as a guide on top of beam or on vertical piping. Fig. 070 also acts as a restrainer to prevent the thrust of a sprinkler head during activation when mounted on top of structure.** Fig. 070 may be installed onto wood using supplied fasteners or into, minimum 20 gauge, steel using two 1/4" X 1" tek type screws. Features flared edges to protect piping as it slides through the installed fitting and retaining dimples to allow for easy installation onto pipe.

ORIENTATIONS:

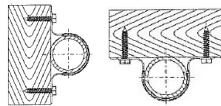

SUPPORT

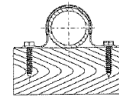

RESTRAINT/GUIDE

APPROVALS: Underwriters Laboratories listed for US and Canada

MATERIAL: Carbon Steel Fitting and two #10 X 1" hardened unslotted indented hex head self threading screws

FINISH: Pre-galvanized G-90

WARNINGS: The safety of the total system involves a system designer, installer, and user. The manufacturer has limited or no control over such factors as environmental conditions, total system design, product selection, and maintenance. The installer is responsible for the application to conform to local codes, the integrity of attaching structure, and the use of proper fasteners. Failure to follow these specifications may result in product malfunction. All load ratings are for static conditions and neglect dynamic loading of any kind. Observe all safety regulations for your surroundings while installing.

INSTALLATION: Clip strap around CPVC pipe or slide over end of pipe, Fig. 070 should slide freely on pipe. Then orient and mount strap to surface where applicable taking into account the maximum spacing allowed between straps. Install in compliance with NFPA 13 and local codes. **DO NOT** use impact tools when installing. No pre-drilling is required when utilizing supplied fasteners.

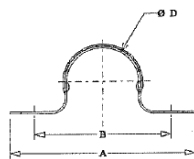

Pipe Size	A	B	D Nominal	Material Size	Max Spacing
3/4	3 1/16	2 3/16	1.050	20 ga. X 1 1/8"	5'-6"
1	3 3/8	2 1/2	1.315	20 ga. X 1 1/8"	6'-0"
1 1/4	3 3/4	2 7/8	1.660	20 ga. X 1 1/8"	6'-6"
1 1/2	4 1/8	3 1/4	1.900	20 ga. X 1 1/8"	7'-0"
2	4 3/8	3 1/2	2.375	20 ga. X 1 1/8"	8'-0"