



"Z" FITTINGS

5570 - 5574 2-Hole "Z" Support

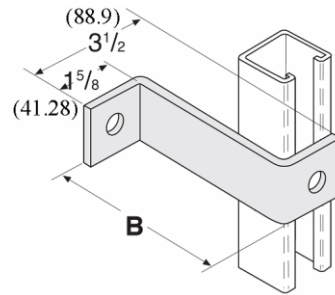

Fig. Number	Length B		Std. Package	Wt. Each	
				lbs.	kg
5570	4	(101.60)	25	.77	(.35)
5571	5	(127.00)	25	.95	(.43)
5572	6	(152.40)	25	.98	(.44)
5573	7	(177.80)	25	1.05	(.48)
5574	8	(203.20)	25	1.20	(.54)

Available in stainless steel. To order, specify 304 or 316 and add suffix SS to fig. number. Price on request.

MATERIAL: $\frac{1}{4} \times 1\frac{5}{8}$ (6.35 X 41.28)

FINISH: Electro-galvanized

ORDERING: Specify figure number and length "B".

HOLE DIM: $\frac{9}{16}$ (14.29) dia. • $\frac{13}{16}$ (20.64) from end

Unless otherwise specified, all dimensions on drawings and in charts are in inches and dimensions shown in parentheses are in millimeters.