



ANGLE FITTINGS

5301 - 5315

2-Hole Open Angle Connector

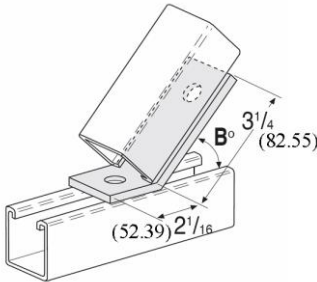

Fig. Number	Angle B°	Std. Package	Wt. Each	
			Lbs.	kg
5301	7½	25	.58	(.26)
5302	15	25	.58	(.26)
5303	22½	25	.58	(.26)
5304	30	25	.58	(.26)
5306	37½	25	.58	(.26)
5307	52½	25	.58	(.26)
5308	60	25	.58	(.26)
5309	67½	25	.58	(.26)
5310	75	25	.58	(.26)
5311	82½	25	.58	(.26)
5315	45	25	.58	(.26)

Available in stainless steel. To order, specify 316 and add suffix SS to fig. number. Price on request.

MATERIAL: ¼ X 1⅝ (6.35 X 41.28)

FINISH: Electro-galvanized

ORDERING: Specify figure number and angle "B".

HOLE DIM: 9/16 (14.29) dia. • 13/16 (20.64) from end

Unless otherwise specified, all dimensions on drawings and in charts are in inches and dimensions shown in parentheses are in millimeters.