



www.phd-mfg.com

BEAM CLAMPS

FIG. 358

RETROFIT RETAINING STRAP

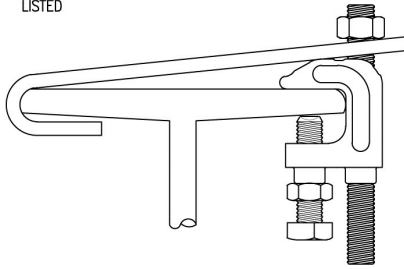
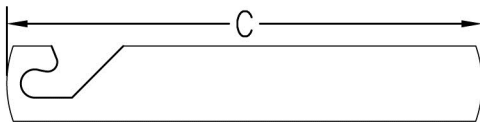

Function: Designed for use with Fig. 345, Fig. 350, and Fig. 360 to offer more secure fastening of beam clamps to beam where seismic protection is provided.

Material: Carbon steel (Type 304 or 316 Stainless Steel upon request)

Finish: Pre-galvanized

Approvals: Underwriters' Laboratories Listed in the U.S. (UL) and Canada (CUL) for 3/8" and 1/2" rod sizes only. Meets NFPA13 requirements for hangers and fasteners subject to earthquakes.

Ordering: Specify figure number, length, rod size, and material.

NOTE: Use jam nut over hanger rod to secure retaining strap. 2 inches (50.8) should be added to beam flange width to determine length.

Rod Size	Wt. Each											
	Length C											
	4 1/2 (114.3)		6 (152.4)		8 (203.2)		10 (254.0)		12 (304.8)		14 (355.6)	
3/8	.06	(.027)	.08	(.036)	.11	(.050)	.14	(.064)	.17	(.077)	.21	(.095)
1/2	.06	(.027)	.08	(.036)	.11	(.050)	.14	(.064)	.17	(.077)	.20	(.091)

THREADED ACCESSORIES
 CPVC STRAPS
 BAND HANGERS
 BEAM CLAMPS
 CLEVIS HANGERS
 PIPE ROLLER SUPPORTS
 SPLIT RING HANGERS
 PIPE CLAMPS
 CENTER LOAD BEAM CLAMPS
 PIPE SHIELDS, INSULATION, & SADDLES
 PIPE GUIDES & SLIDES
 WALL BRACKETS
 PIPE SUPPORTS
 STRUCTURAL ATTACHMENTS
 SEISMIC BRACING